

During installation:
Make sure you accept the default settings and/or unblock, unless other instructions are given in the Installation Guide and other instruction material.

I GET TO KNOW THE SUPPORT MATERIALS

- SimJunior Installation Guide - this document
- SimJunior DFU - included with your SimJunior
- VitalSim DFU - included with your VitalSim
- SimJunior Simulator Software help files on Software CD

II CHECK THAT ALL ITEMS ARE PRESENT



© 2011 Laerdal Medical. All Rights reserved
PN 20-04690

CHECK EQUIPMENT

(Images below are examples only. Actual components may vary.)

SimJunior Advanced Components

<p>Computer with accessories:</p> <ul style="list-style-type: none"> - Power supply with cable - USB mouse 	<p>USB Hub Box with Power supply and USB cable</p>	<p>USB Camera Box</p>
<p>Monitor with accessories:</p> <ul style="list-style-type: none"> - Video cable - Power supply with cable - USB cable 	<p>Audio cable, 3-way</p>	
<p>Cables NOT to be used</p> <ul style="list-style-type: none"> - Digital Video Cable (white connectors) - Audio Cable (2-way) 		

SimJunior - Components Required for Setup

- Control Unit
- Remote Control
- Power supply (2)
- USB cable
- Manikin cable, 10 ft
- Remote control cable
- Internal manikin battery



1 START THE INSTRUCTOR COMPUTER

- Start the Instructor PC.
- Connect the mouse and power supply to the computer and power ON.
- Make sure that the SimJunior simulator icon is displayed on the Instructor PC desktop.



2 INSTALL THE USB HUB

- Connect Power to the USB hub.
- Connect USB hub to Instructor PC.

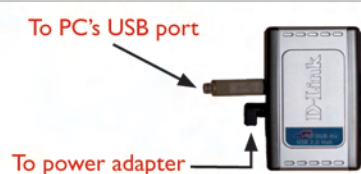

3 CONNECT THE PATIENT MONITOR CABLES

- Put aside the software CD that comes with the monitor. DO NOT INSTALL software CD.
- Route the cables through the Patient Monitor stand and connect them to the corresponding outlets located at the bottom of the screen.

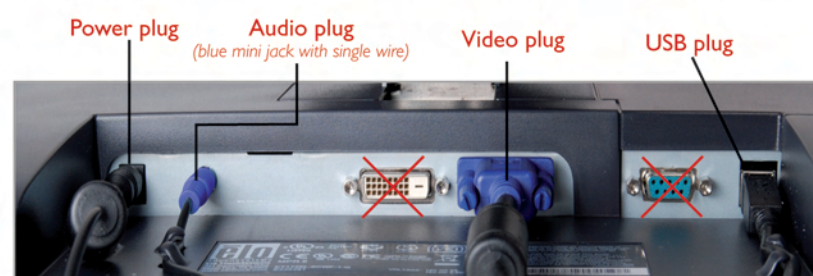

- Secure the cables using the strain reliefs.
- Connect power cable to a wall outlet and power ON the Patient Monitor.

IMPORTANT: Do NOT connect the USB cable to the USB hub yet.

IMPORTANT: Do NOT use the Patient Monitor software CD that comes with the Manikin.

4 CONNECT THE PATIENT MONITOR TO THE INSTRUCTOR COMPUTER

- Connect the Patient Monitor video cable and 3-way audio cable (black mini jack with double wire) to the Instructor PC.

IMPORTANT: Do NOT connect the USB cable to the Patient Monitor yet.

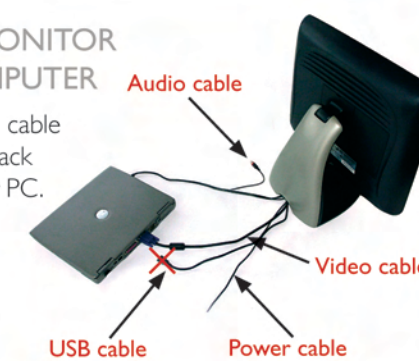

5 SET UP THE INSTRUCTOR PC FOR EXTENDED DESKTOP DISPLAY TO SUPPORT THE PATIENT MONITOR

- Right click on the instructor PC desktop.
- In the drop down menu select <Screen Resolution>.
- In the <Multiple Displays> option, select <Extend these displays>.
- Click <Apply>.
- The Instructor PC (display 1) should have a resolution of 1600 x900.
- The Patient Monitor (display 2) should have a resolution of 1280 x 1024.

6 CONNECT THE MONITOR TO THE USB HUB

7 CALIBRATING THE TOUCHSCREEN PATIENT MONITOR

- Double-click on the Elo logo in the system tray in the lower right corner of the screen.
- Click the button on the dialog box that appears.
- If target indicators first appear on the Instructor PC (laptop computer) screen, press Esc, or wait until they appear on the Patient Monitor.
- When the target indicator appears on the Patient Monitor; touch each target as it changes position.
- When the ELO Touchscreen dialog box appears, touch the green "checkbox" button.
- Click OK.



8 CONNECT THE USB CAMERA TO THE USB HUB

9 CONNECT THE VITALSIM CONTROL UNIT

- Connect the USB cable from the VitalSim Control Unit to the USB hub.
- Connect the audio cable (white mini jack with single wire) to the VitalSim Control Unit.
- Connect the power cable to the Control Unit and power source.

10 CONNECT THE MANIKIN TO THE VITALSIM CONTROL UNIT

- Connect the 37-Pin Serial Cable (Manikin to VitalSim Cable) to the VitalSim Control Unit.
- Place the Blood Pressure cuff on the left arm of the manikin.
- Connect the clear tubing from the Blood Pressure cuff to the VitalSim Blood Pressure connector on the back of the VitalSim Control Unit.
- Connect the Manikin to a power supply.
- Power on the VitalSim Control Unit.



You are now ready to start using your SimJunior Advanced system

Setup of SimJunior Components

